

Palm-sized 4MP 3X IR Dome PTZ Camera



8140IEN(PE/03M/AR2)



Introduction:

BX-8140IEN could output max 2688x1520@30fps ultra HD stream over a middle scene. With the 3x optical lens, it could replace the 2.8mm, 4mm, 6mm and 8mm lens models by one, reducing SKU. The PTZ camera has a tiny gimbal which supports preset and cruise function. Installers and customers could adjust to best view angle and best view distance by remote control, without disassembly of lens dome cover and avoid fingerprints and wall dusts.

The PTZ has built-in 1.5Tops AI engine, which supports multiple faces, human and bi-wheels vehicles detection, classification, capture, and smart tracking. In a typical dim scene, upon detecting of illegal intrusion, the camera will trace moving object, zoom fit in the center screen, triggering snap and recording details until the object leave out of the perimeter area or time expired.

The H.265 encoder could reduce video bandwidth to 50% of H.264 without loss of image details. The PTZ conforms to the ONVIF specifications ensuring interoperability between network video products regardless of manufacturers, and also complies with latest network safety and data protection issue such as GDPR, NDA 2019, PSTI.

The PTZ adopts hidden IR and ultra slim design, especially suited for in-ceiling mounting. With allium alloy and polycarbonate bubble it could suffer IK10 vandalism impact and IP67 water immersion, and could also work in outdoor weather.

Key Spec:

- Up to 2688x1520 resolution
- Mini illumination:
Color: 0.02 lux @ (F1.6 AGC ON)
- 3X optical zoom, fast and accurate
- Pan 80 %S , Tilt80 %S
- Smart IR
- Built-in Mics
- Smart H.265+/H.265/H.264+/H.264
- AI-based face, human, vehicle detection and recognition
- Smart-tracking, perimeter precaution, line crossing, etc.
- Micro SD card chamber, Reset button, Alarm in/out
- PoE and DC12V power supply, easy connection
- IP67, IK10
- ONVIF, API, SDK, IE/NVR/VMS/free mobile Apps

Application:

With ultra slim design and good image quality and protection, this PTZ camera could meet the demand of small size of video surveillance, which is suitable for luxury and retail shop, small office, coffee bar, apartment, etc.

Suggest installation height: 3m to 4m in height.

SPECIFICATION:

Camera Module					
Image sensor	1/2.7" progressive scan CMOS with BSI and NIR+ technology				
Max Resolution	2688x1520(4.08MP)				
Mini. Illumination	Color:0.02 Lux @ (F1.6,AGC ON); B/W: 0.004 Lux @ (F1.6, AGC ON); 0 Lux with IR				
Image setting	Saturation, Brightness, Contrast, Sharpness, AGC, and AWB adjusted by client				
Shutter Speed	50Hz: 1/25s~1/25,000s, 60Hz: 1/30s~1/30,000s				
White Balance	Auto/Manual/Indoor/Outdoor				
Gain	Auto/Manual				
Day & Night	Auto/Manual				
Aperture control	N/A				
S/N Ratio	≥52dB				
3D DNR	Auto/Manual				
AE Enhancement	BLC, HLC, DWDR(suggest in still mode)				
Digital Zoom	8X				
Privacy Mask	4 Programmable privacy masks				
Picture overlay	Logo picture could be overlaid on video with 128x128pixels,24bits JPG format				
Font overlay	Max 15characters per line, 8lines max, white color or red color				
OSD	Time, Date, Device Name, Zoom ratio, Direction(N/S/E/W),PTZ Status, etc.				
Lens					
Focus length	f=3.18mm~7.42mm(wide-tele) ±5%, about 3x optical zoom AF lens				
Zoom Speed	1 second(Wide->tele)				
Field of View	Horizontal: 113.6 °(W)-44.3 °(T); Vertical :59.6 °(W)-24.9 °(T) ; Diagonal:137.4 °(W)-50.8 °(T); ±5%				
Mini View Distance	40cm				
Aperture Range	F1.6 ~ F2.7 (wide-tele) ±10%				
IR Cut filter	Switchable ICR				
DORI table	Lens	Detect(25px/m)	Observe(63px/m)	Recognize(125px/m)	Identify(250px/m)
	f=3.18mm	62.8m(206 f.t)	24.9m(81.7 f.t)	12.56m(41.2f.t)	6.28m(20.6 f.t)
	f=7.42mm	148.4m(487 f.t)	58.89m(193 f.t)	29.68m (97.4 f.t)	14.84m(48.7f.t)
PTZ					
Pan Range	0~355 °				
Pan speed	Configurable, from 0.5~80 %; Preset speed: 80 %s				
Tilt Range	From 15 °to 90 °(auto flip at 90 °) , (±1 °)				
Tilt Speed	Configurable, from 0.5 %~ 80 %s, Preset speed: 80 %s				
Pan/Tilt intervals	Default 300seconds, min 120seconds, max 3600 seconds. Customized per request				
Proportional Zoom	Yes				
Preset	360				
Cruise	8 cruises, up to 16 presets for each cruises				
Trace	N/A				
Power off memory	Support				
Action mode	Preset/Cruise(No trace or scan)				
3D Positioning	Support				
PTZ Position Display	Support				
Schedule Task	Preset/Cruise/Dome reboot				
Supplement Light					
IR Distance	Up to 20m, 4pcs 850nm				
Smart IR	Yes				
Network					
Main stream	25fps:(2688×1520, 2560×1440, 2048×1536, 1920×1080, 1280×960, 1280×720); 30fps:(2688×1520, 2560×1440, 2048×1536, 1920×1080, 1280×960, 1280×720)				
Sub stream	25fps (704 ×576, 640 ×480, 352 ×288); 30fps (704 ×480, 640 ×480, 352 ×240)				
Third Stream	25fps (1920 ×1080, 1280 ×960, 1280 ×720, 704 ×576, 640 ×480, 352 ×288) 30fps (1920 ×1080, 1280 ×960, 1280 ×720, 704 ×480, 640 ×480, 352 ×240)				

Video compression	Smart H.265+/H.265/H.264+/H.264/MJPEG
H.264 Encoder	H.264/AVC codec BP/MP/HP, level 5.1
H.265 Encoder	H.265/HEVC codec MP, level 5.0
Video bit rate	H.264: 128kbps~16,384 kbps; H.265: 51 kbps~12,288kbps
Audio Compression	G.711 A/U
Audio bit rate	64Kbps
Protocols	HTTP, HTTPS, IPv4/IPv6, 802.1x, QoS, FTP, SMTP, UPnP, SNMP,DNS, DDNS, NTP, RTSP, RTCP, RTP, TCP/IP, UDP, IGMP, ICMP, DHCP, PPPoE, P2P
User / Host	Up to 16 users, 3 levels: Administrator, Advanced User and Normal User
Security Measures	User authentication (ID and PW), Host authentication (MAC address); HTTPS encryption, IEEE802.1x port-based network access control; IP address filtering
API	ONVIF G/S/T, support BNX SDK and third-party management platform
Client	BNX N9000 1.4.7, BNX NVMS 2.0; and the third-party client, free iOS and Android App
Web Browser	IE8-11 with plug-in; Edge, Chrome, Firefox with plugin free
Smart Features	
Basic event	Motion detection, video tampering alarm, exception (network disconnected, IP address conflict, SD full, SD error)
Face recognize	(Default off) human face detection, capture and face comparison.
Road traffic	Vehicle detecting and tracking, etc.
Smart Detection	Tripwire, Bi-directional tripwire, Illegal intrusion detection, Region entrance detection, Region exiting detection, etc. More VCA per request.
Smart Tracking	Smart tracking of human or vehicle, auto/manual
System Integration	
Audio Interface	1CH audio input, 2 to 2.4v[p-p] 1KΩ ±10%,bare Wire; 1CH audio output (line out), impedance: 600Ω,bare wire
Built-in mic	1-ch mic
Built-in Speaker	N/A
Audio device switch	Default use built-in MIC, manually switch to external
Alarm interface	1CH alarm input(DRY Connection); 1CH alarm output
Alarm Linkage	Alarm actions, such as Preset, Cruise, Memory Card Video Record, Trigger Recording, Notify Surveillance Center, Upload to FTP/Memory Card, Send Email, etc.
Network Interface	1 RJ45 10M/100M Adaptive Ethernet (Support PoE)
Storage Slot	Card chamber, support microSD/TF card, up to 256GB
Serial interface	No RS485/RS232
Auxiliary video	N/A
Reset button	Yes
Heat and Fan	N/A
Water removal	Dust and Water-resistant coating for dome cover
General	
Languages	Czech; English, German; Hungarian ; Italian ; Japanese ; Korean ; Portuguese, Polish; Russian, Romanian, Spanish; Spanish(Mexico); Simplified Chinese; Turkish; Traditional Chinese. etc.
Power	DC12V ±20% 2000mA or PoE(802.3.af). avg 7Watt;max 12Watt (IR + PTZ working)
Working condition	-30 °C ~ 60 °C (-22 °F ~ 140 °F) IR off, -30°C ~ 40°C IR on; Cold start≥- 20°C(1Hour waiting), ≤90%RH
Storage condition	-40°C ~ 60°C ; ≤ 95% RH
Protection	6000V Lightning Protection, Surge Protection and Voltage Transient Protection
Shield Material	Main body: Aluminum Alloy(ADC12); Bubble: Polycarbonate
Dim& Net weights	∅ 116mm x 75mmH (∅ 4.56'x 2.95'), Approx. 463g(1 lb.)
Certification	IP67,IK10(include lens bubble), ROHS,CE,FC,UKCA,KC,BIS



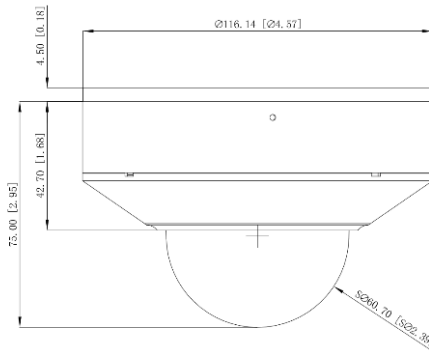

Ordering information

BX-8140IEN(PE/03M/AR2)	1.8inch 4MP 3x zoom Network AI IR Dome PTZ camera, with flash mount adaptor. Support DC12V/PoE, IP67/IK10, not include power adaptor
------------------------	---

Dimension(mm/inch):



Mounting Options:

BX-YZJ1102(included)	BX-YZJ0209	BX-YZJ0209+BX-YZJ0601	BX-YZJ0209+BX-YZJ0502	BX-YZJ0814
In-ceiling mounting	Wall-mounting	Corner mounting	Pole-mounting	Pendant mounting
				

Accessories:

Included :



BX-YZJ1102

Fast mount adaptor (also hook other brackets)

Optional:



BX-YZJ0209
Wall-mounting bracket



BX-YZJ0209+YZJ0601
Corner mounting bracket



BX -YZJ0209+YZJ0502
Pole mounting bracket



BX-YZJ0814
Pendant mounting bracket



BX-YZJ0211
Wall-mounting bracket
with junction-box



BX-YZJ0211+YZJ0601
Corner mounting bracket
with junction-box



BX-YZJ0211+YZJ0501
Pole mounting bracket
with junction-box



BX-YXH0101B
Junction box



DC12V2000mA
Power adaptor



BX-K22
PTZ Network Joystick & Keyboard



BX-K23
PTZ Network Joystick & Keyboard

*All texts, pictures and data subject to change without notice